

CATCH BASIN

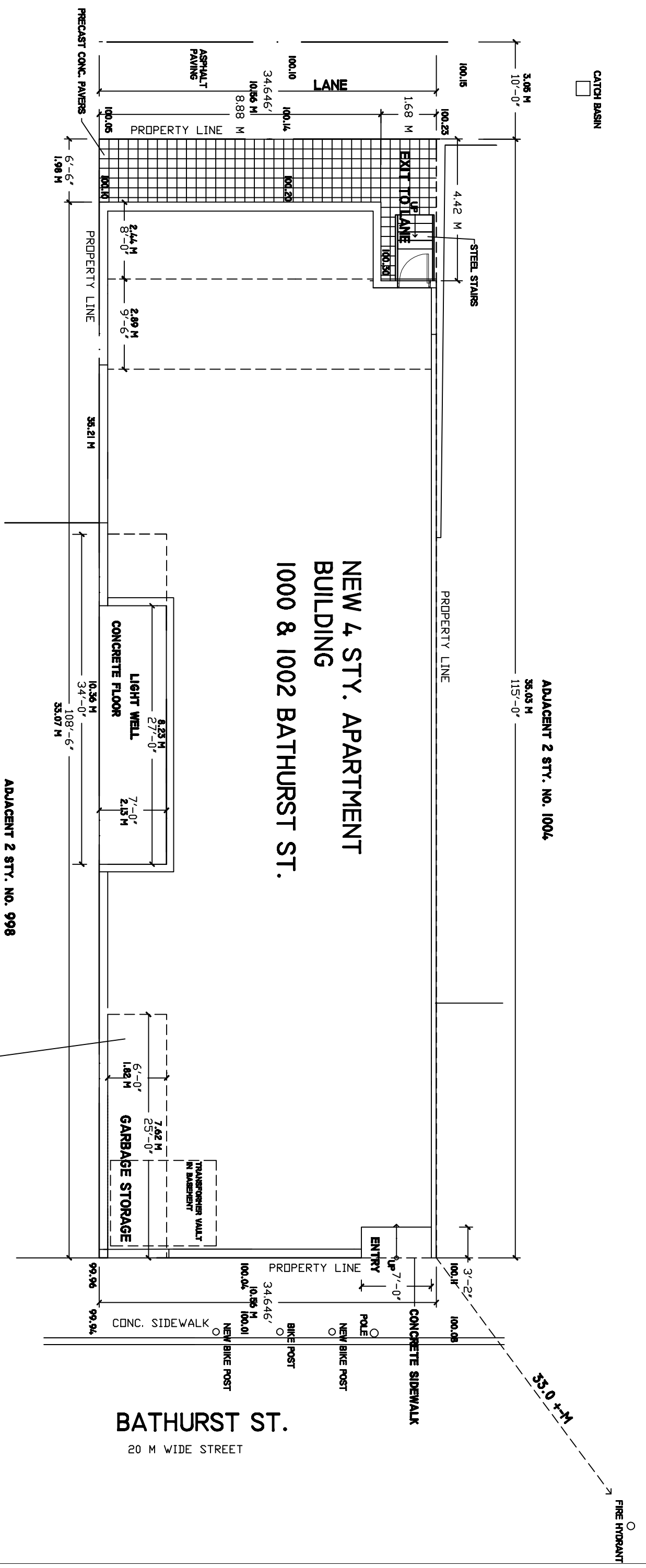

**NEW 4 STY. APARTMENT BUILDING**  
**1000 & 1002 BATHURST ST.**

**STATISTICS**

**LOT AREA = 3,984.29 SF 370.14 SM**

**BASEMENT FLOOR GFA = 2,770 SF 257.30 SM**  
**GROUND FLOOR GFA = 3,372 SF 313.26 SM**  
**2 ND FLOOR GFA = 3,244 SF 301.36 SM**  
**3 RD FLOOR GFA = 3,244 SF 301.36 SM**  
**4 TH FLOOR GFA = 2,915 SF 270.79 SM**

**TOTAL GFA = 15,545 SF 1,444.10 SM**

**COVERAGE 3.91 X**

**UNITS 1 BED RM = 8**  
**UNITS 2 BED RM = 9**

**TOTAL APARTMENT UNITS 17**

**SITE PLAN**

SCALE: 3/32"=1'-0"



**META FORM ARCHITECTS INC.**  
 608 ORTIOLE PARKWAY  
 TORONTO, ONT.  
 MAR 263  
 TEL. 416 520-0552  
 FAX 416 545-1421

**NEW APARTMENT BUILDING**  
**1000 & 1002 BATHURST ST. TORONTO, ONT.**  
**SITE PLAN**  
 DATE: MAY 08, 2012 SCALE: 3/32"=1'-0"